

RIFLE BASIX REM-SAF

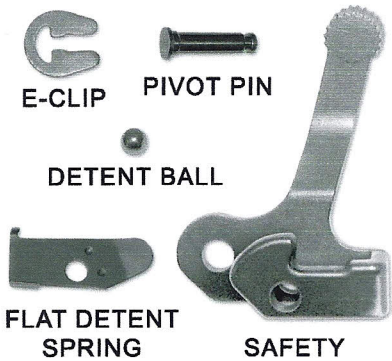

INSTALLATION INSTRUCTIONS

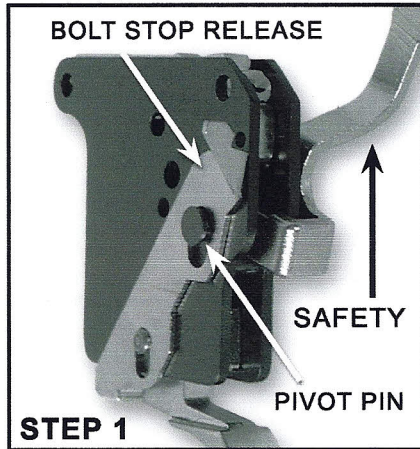

STEP 1
Install bolt stop release and safety, insert safety pivot pin.

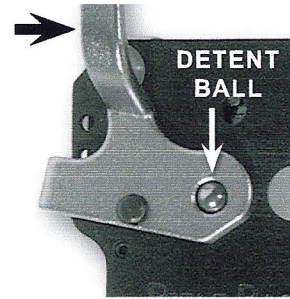

STEP 2
With safety in the FIRE position, insert detent ball.

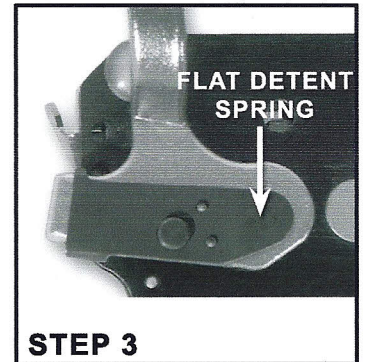

STEP 3
Install flat detent spring over safety pivot pin.

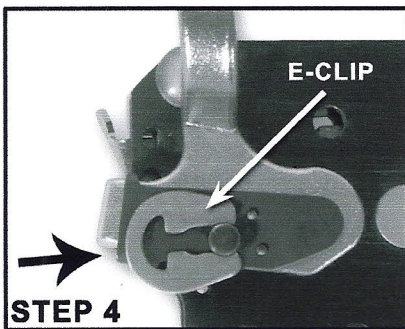

STEP 4
Install e-clip in the same direction as arrow on safety pivot pin.

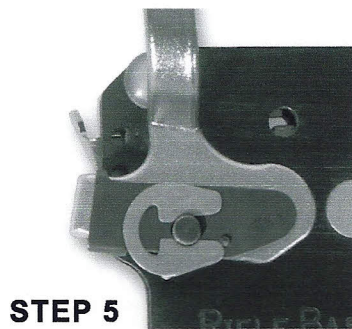

STEP 5
Push e-clip forward until it is seated in rotational notch.

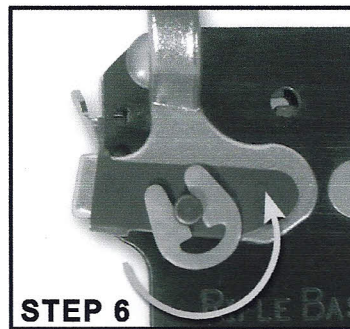

STEP 6
Rotate e-clip in direction of arrow (counter clock-wise)...

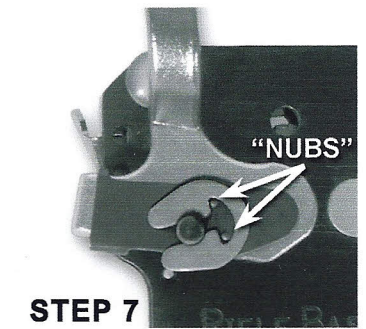

STEP 7
to final position, wedged by raised detent spring "nubs".